

U 4.40

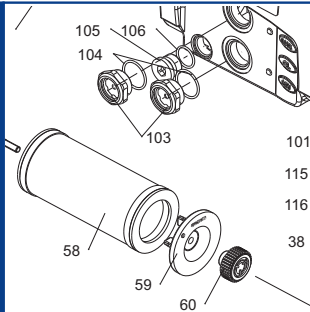

SERVICE

BECKER
D-42279 Wuppertal
www.becker-international.com

No. **B** year XXXX

type **U 4.40-XX** Index Variante

frequency XXXX Hz
speed XXXX min⁻¹
power required XXXX kW
inlet capacity XXXX m³/h
pressure + XXXX mbar
vacuum - XXXX mbar

Made in Germany

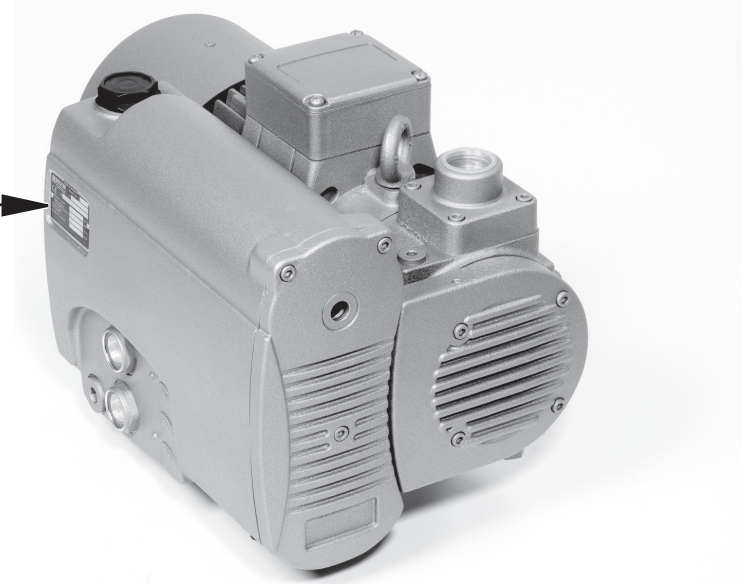

Ersatzteilliste
Spare parts list
Liste de pièces de rechange
Listino pezzi di ricambio
Lista de piezas de recambio
Lista de peças sobresselentes
Reserveonderdelenlijst
Atsarginių dalių sąrašas
Varuosad nimekirja
Rezerves daļu saraksts

Reservedelsliste
Reservdelslista
Varaosaluettelo
Reservedelsliste
Wykaz części zamiennych
Tartalékalkatrész lista
Seznam náhradních dílů
Seznam nadomestnih delov
Zoznam náhradných dielov
Rezervni dijelovi popis

Lista pieselor de schimb
Páirteanna spártha liosta
Κατάλογος ανταλλακτικών
Yedek parça listesi
Списък на резервните части
Перечень запасных частей
スペアパーツリスト
예비 부품 목록
备用零件目录

SERVICE

www.becker-international.com

Sales and service network

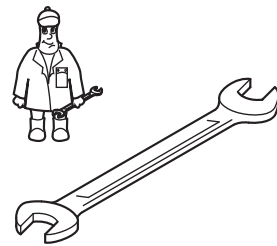

Wartung
Maintenance
Entretien
Manutenzione
Mantenimiento



Pos.	Menge ²⁾ Quantity Quantité Quantità Cantidad	Bestell-Nr. Ident No. No. Identification No. Identificazione No. de pedido	Bezeichnung Description Designation Designazione Descripción
□	1	549000 40500	Dichtungssatz, Complete set of seals, Jeu de joints, Kit di guarnizioni, Junta Completa
7	SATZ/KIT	900585 00003	Schieber, Rotor Vane, Palette, Empujador
58	1	965414 00000	Luftentölelement, Oil separating element, Element separation huile, Cartuccia separatore olio, Elemento de desaceitar de aire

²⁾ erforderliche Bestellmenge / necessary order quantity / quantité nécessaire / quantità di ordinazione necessari / cantidad necesario

U 4.40 (~3) Standard



Variante



U 4.40/XX

①

- 1~ Einphasenwechselstrom
- 1~ single-phase AC
- 1~ AC monophasé
- 1~ AC monofase
- 1~ AC monofásica

②

/09

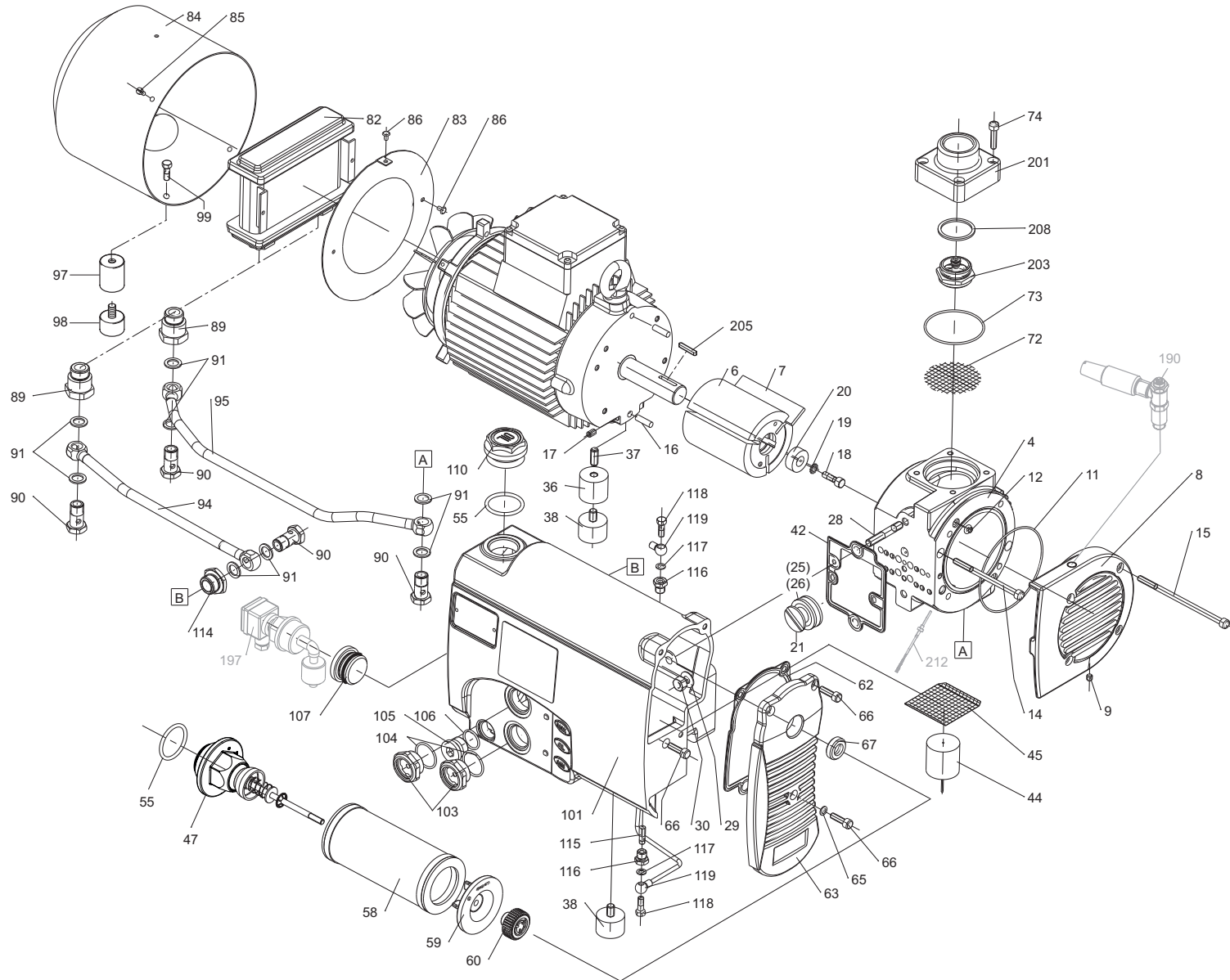

- mit Gasballastventil
- with gas ballast valve
- avec l'este d'air
- con valvola di zavoratrice
- con valvula de lastre de gas



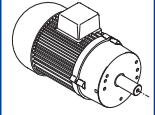
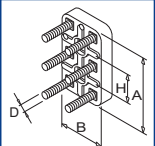
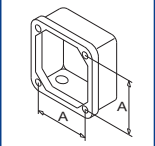
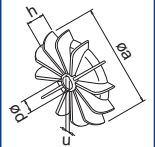
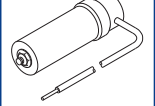

SERVICE ?

 C = ? μ F
U = ? V



B INDEX	Pos.	Bestell Nr.	Beschreibung	
U 4.40	▣	549000 40500	DICHTUNGSSATZ ¹⁾	
	4	500102 40500	GEHÄUSE, KOMPLETT	
	6	020000 40500	KOLBEN	
	7	900585 00003	SCHIEBER (SATZ) ²⁾	
	8	000701 40500	SEITENDECKEL	
	9	945618 00000	GEWINDESTIFT	
	14	945373 00000	INNENSECHSKANTSCHRAUBE	
	15	945374 00000	INNENSECHSKANTSCHRAUBE	
	16	947628 01000	ZYLINDERSTIFT	
	17	945801 01000	GEWINDESTIFT	
	18	901807 00000	WELLENENDSCHRAUBE	
	19	949203 00000	ZAHNSCHEIBE	
	20	016800 05000	SPANNSCHEIBE	
	21	537500 26200	VENTIL, KOMPL.	
	28	946917 00000	STIFTSCHRAUBE	
	29	917107 00000	TELLERFEDER	
	30	947105 00000	SECHSKANTMUTTER	
	36	068101 40500	ZWISCHENSTÜCK	
	37	945634 00000	GEWINDESTIFT	
	38	741310 60000	GUMMIPUFFER	
	44	867800 99559	SCHWIMMER	
	45	005001 40300	SIEB	
	47	727503 99628	ABBLASEVENTIL	
	58	965414 00000	LUFTENTÖLELEMENT (1x) ²⁾	
	59	016802 40300	SPANNSCHEIBE	
	60	921500 50000	HANDGRIFF	
	63	003700 40500	DECKEL	
	66	945320 00000	INNENSECHSKANTSCHRAUBE	
67	953116 00000	DÜSE		
72	005000 40500	SIEB		
74	945321 00000	INNENSECHSKANTSCHRAUBE		
82	960201 40500	KÜHLER		
83	917800 40500	HALTERRING		
84	960702 40500	LÜFTERHAUBE (~3)		
85	946308 00000	ZYLINDERSCHRAUBE		
86	948750 00000	BLINDNIET		
89	912317 00000	ANSCHLUSS-SCHRAUBE		
90	948407 00000	HOHLSCHRAUBE		
94	012207 40500	LEITUNG (~3)		
95	012208 40500	LEITUNG (~3)		
97	068100 40300	STÜTZE		
98	741310 80000	GUMMIPUFFER		
99	945218 00000	SECHSKANTSCHRAUBE		
101	002402 40500	ÖLABSCHEIDERGEHÄUSE		
103	907309 00000	ÖLSCHAUGLAS		
105	951219 00000	VERSCHLUSS-SCHRAUBE		
107	951221 00100	VERSCHLUSS-SCHRAUBE		
110	916800 10000	SCHRAUBDECKEL		
114	912318 00000	ANSCHLUSS-SCHRAUBE		
115	003300 10700	DÜSE		
116	912300 00000	ANSCHLUSS-SCHRAUBE		
118	009400 19000	KUGELSTÜCKSCHRAUBE		
119	012200 40300	LEITUNG		
197	741103 99682	NIVEAUGEBER - OPTIONAL		
201	007801 40500	GEWINDEFLENSCH		
203	537506 99633	RÜCKSCHLAGVENTIL		
205	947701 00000	PASSFEDER		
212	943402 60000	TEMPERATURFÜHLER PT100 - OPTIONAL		

B INDEX	Pos.	Bestell Nr.	Beschreibung	
		960009 00000 960016 00100 960023 00100	BECKER LUBE M 100 (MINERALÖL) - 1L BECKER LUBE S 100 (SYNTHETIKÖL) - 1L BECKER LUBE SL 100 (LEBENSMITTELBEREICH) - 1L	
¹⁾ Dichtungssatz - 549000 40500 - Pos.: 11, 12, 25, 26, 42, 55, 62, 65, 73, 91, 104, 106, 117, 147, 208				
²⁾ erforderliche Bestellmenge / Wartung				



B INDEX	Pos.	Ident No.	Description	
U 4.40	▣	549000 40500	SET OF SEALS ¹⁾	
	4	500102 40500	PUMP BODY	
	6	020000 40500	ROTOR	
	7	900585 00003	VANES (KIT) ²⁾	
	8	000701 40500	LID	
	9	945618 00000	THREADED PIN	
	14	945373 00000	SOCKET HEAD SCREW	
	15	945374 00000	SOCKET HEAD SCREW	
	16	947628 01000	STRAIGHT PIN	
	17	945801 01000	THREADED PIN	
	18	901807 00000	SCREW	
	19	949203 00000	TOOTHED SPRING WASHER	
	20	016800 05000	CLAMPING DISC	
	21	537500 26200	VALVE	
	28	946917 00000	STUD	
	29	917107 00000	CUP SPRING	
	30	947105 00000	HEX.NUT	
	36	068101 40500	FLANGES	
	37	945634 00000	THREADED PIN	
	38	741310 60000	RUBBER BUFFER	
	44	867800 99559	FLOAT	
45	005001 40300	SIEVE		
47	727503 99628	BLOW-OFF VALVE		
58	965414 00000	OIL SEPARATING ELEMENT (1x) ²⁾		
59	016802 40300	CLAMPING DISC		
60	921500 50000	HANDLE		
63	003700 40500	COVER		
66	945320 00000	SOCKET HEAD SCREW		
67	953116 00000	NOZZLE		
72	005000 40500	METAL FILTER		
74	945321 00000	SOCKET HEAD SCREW		
82	960201 40500	COOLER		
83	917800 40500	RETAINING RING		
84	960702 40500	VENTILATOR HOOD (~3)		
85	946308 00000	CYLINDER SCREW		
86	948750 00000	BLIND RIVET		
89	912317 00000	CONNECTING SCREW		
90	948407 00000	HOLLOW SCREW		
94	012207 40500	PIPE (~3)		
95	012208 40500	PIPE (~3)		
97	068100 40300	SUPPORT PILLAR		
98	741310 80000	RUBBER BUFFER		
99	945218 00000	HEX. HEAD SCREW		
101	002402 40500	HOUSING FOR OIL SEPARATOR		
103	907309 00000	OIL SIGHT GLASS		
105	951219 00000	LOCKING SCREW		
107	951221 00100	LOCKING SCREW		
110	916800 10000	COVER		
114	912318 00000	CONNECTING SCREW		
115	003300 10700	NOZZLE		
116	912300 00000	CONNECTING SCREW		
118	009400 19000	HOLLOW HOLDING SCREW		
119	012200 40300	PIPE		
197	741103 99682	OIL LEVEL CONTROL - OPTIONAL		
201	007801 40500	SCREWED FLANGE		
203	537506 99633	NON RETURN VALVE		
205	947701 00000	KEY		
212	943402 60000	TEMPERATURE SENSOR - OPTIONAL		

B INDEX	Pos.	Ident No.	Description	
		960009 00000 960016 00100 960023 00100	BECKER LUBE M 100 (MINERAL OIL) - 1L BECKER LUBE S 100 (SYNTHETIC OIL) - 1L BECKER LUBE SL 100 (FOOD SECTOR) - 1L	
¹⁾ Set of seals - 549000 40500 - Pos.: 11, 12, 25, 26, 42, 55, 62, 65, 73, 91, 104, 106, 117, 147, 208 ²⁾ necessary order quantity / maintenance				



B INDICE	Pos.	No. Identification	Designation	FR	
U 4.40	▣	549000 40500	JEU DE JOINTS ¹⁾		
	4	500102 40500	CARCASSE		
	6	020000 40500	PISTON		
	7	900585 00003	PALETTES (KIT) ²⁾		
	8	000701 40500	COUVERCLE		
	9	945618 00000	GOUPILLE FILETEE		
	14	945373 00000	VIS HEXAGONALE INTERNE		
	15	945374 00000	VIS HEXAGONALE INTERNE		
	16	947628 01000	GOUPILLE CYLINDRIQUE		
	17	945801 01000	GOUPILLE FILETEE		
	18	901807 00000	VIS		
	19	949203 00000	DENT DISQUE		
	20	016800 05000	DISQUE DE SERRAGE		
	21	537500 26200	SOUPAPE		
	28	946917 00000	PRISONNIER		
	29	917107 00000	RESSORT BELLEVILLE		
	30	947105 00000	ECROU A 6 PANS		
	36	068101 40500	BRIDES		
	37	945634 00000	GOUPILLE FILETEE		
	38	741310 60000	AMORTISSEUR EN CAOUTCHOUC		
	44	867800 99559	PIED CAOUTCHOVE		
45	005001 40300	FILTRE			
47	727503 99628	SILENCIEUX			
58	965414 00000	ELEMENT SEPARATION HUILE (1x) ²⁾			
59	016802 40300	DISQUE DE SERRAGE			
60	921500 50000	POIGNEE			
63	003700 40500	COUVERCLE			
66	945320 00000	VIS HEXAGONALE INTERNE			
67	953116 00000	BUSE			
72	005000 40500	FILTRE EN METAL			
74	945321 00000	VIS HEXAGONALE INTERNE			
82	960201 40500	REFROIDISSEUR			
83	917800 40500	BAGUE DE MAINTIENT			
84	960702 40500	CARTER DE VENTILATEUR (~3)			
85	946308 00000	TETE A VIS CYLINDRIQUE			
86	948750 00000	RIVET AVEUGLIE			
89	912317 00000	VIS DE RACCORD			
90	948407 00000	VIS CREUSE			
94	012207 40500	TUYAU (~3)			
95	012208 40500	TUYAU (~3)			
97	068100 40300	SUPPORT INTERMEDIAIRE			
98	741310 80000	AMORTISSEUR EN CAOUTCHOUC			
99	945218 00000	VIS HEXAGONALE			
101	002402 40500	CORP DE SEPARATEUR D'HUILE			
103	907309 00000	VERRE REGARD			
105	951219 00000	BOUCHON			
107	951221 00100	BOUCHON			
110	916800 10000	COUVERCLE			
114	912318 00000	VIS DE RACCORD			
115	003300 10700	GICLEUR			
116	912300 00000	VIS DE RACCORD			
118	009400 19000	VIS CREUSE DE FIXATION			
119	012200 40300	TUYAU			
197	741103 99682	INDICATEUR DE NIVEAU - EN OPTION			
201	007801 40500	BRIDE FILETEE			
203	537506 99633	SOUPAPE ANTI-RETOUR			
205	947701 00000	CLAVETTE			
212	943402 60000	SONDE DE TEMPÉRATURE - EN OPTION			







B INDICE	Pos.	No. Identification	Designation	FR	
		960009 00000 960016 00100 960023 00100	BECKER LUBE M 100 (HUILE MINÉRALE) - 1L BECKER LUBE S 100 (L'HUILE SYNTHÉTIQUE) - 1L BECKER LUBE SL 100 (SECTEUR DE L'ALIMENTATION) - 1L		
¹⁾ Jeu de joints - 549000 40500 - Pos.: 11, 12, 25, 26, 42, 55, 62, 65, 73, 91, 104, 106, 117, 147, 208 ²⁾ quantité nécessaire / entretien					

B INDICE	Pos.	No. Identificazione	Designazione	
U 4.40	▣	549000 40500	SERIE DI GUARNIZIONE ¹⁾	
	4	500102 40500	CARCASSA	
	6	020000 40500	ROTORE	
	7	900585 00003	PALETTE (KIT) ²⁾	
	8	000701 40500	COPERCHIO	
	9	945618 00000	SPINA FILETTATURA	
	14	945373 00000	VITE ESAGONALE INTERNA	
	15	945374 00000	VITE ESAGONALE INTERNA	
	16	947628 01000	PERNO	
	17	945801 01000	SPINA FILETTOTA	
	18	901807 00000	VITE	
	19	949203 00000	DISCO A DENTE	
	20	016800 05000	DISCO DI FISSAGGIO	
	21	537500 26200	VALVOLA	
	28	946917 00000	L'ASTA A VITE	
	29	917107 00000	MOLLA A DISCO	
	30	947105 00000	DADO ESAGONALE	
	36	068101 40500	FLANGE	
	37	945634 00000	SPINA FILETTATURA	
	38	741310 60000	AMMORTIZZATORE IN GOMMA	
	44	867800 99559	GALLEGGIANTE	
45	005001 40300	FILTRO		
47	727503 99628	SILENZIATORE		
58	965414 00000	CARTUCCIA SEPARATORE OLIO (1x) ²⁾		
59	016802 40300	DISCO DI FISSAGGIO		
60	921500 50000	MANETTA		
63	003700 40500	COPERCHIO		
66	945320 00000	VITE ESAGONALE INTERNA		
67	953116 00000	UGGELLO		
72	005000 40500	FILTRO METALLICO		
74	945321 00000	VITE ESAGONALE INTERNA		
82	960201 40500	RAFREDDATORE		
83	917800 40500	ANELLO PORTANTE		
84	960702 40500	CARTER DEL VENTILATORE (~3)		
85	946308 00000	VITE A TESTA CILINDRICA		
86	948750 00000	RIVETTO CIECO		
89	912317 00000	ATTACO FILETTATO		
90	948407 00000	VITE ESAGONALE		
94	012207 40500	CONDOTTO (~3)		
95	012208 40500	CONDOTTO (~3)		
97	068100 40300	SUPPORTO		
98	741310 80000	AMMORTIZZATORE IN GOMMA		
99	945218 00000	VITE ESAGONALE		
101	002402 40500	CARCASSA SEPARAZIONE OLIO		
103	907309 00000	SPIA LIVELLO OLIO		
105	951219 00000	VITE DI CHIUSURA		
107	951221 00100	VITE DI CHIUSURA		
110	916800 10000	COPERCHIO		
114	912318 00000	ATTACO FILETTATO		
115	003300 10700	UGELLO		
116	912300 00000	ATTACO FILETTATO		
118	009400 19000	VITE PASSAGGIO OLIO		
119	012200 40300	CONDOTTO		
197	741103 99682	SONDA D'OLIO - OPTIONALE		
201	007801 40500	FILANGIA		
203	537506 99633	VALVOLA NON RITORNO		
205	947701 00000	CHIAVETTA		
212	943402 60000	SONDA TERMICA - OPTIONALE		

B INDICE	Pos.	No. Identificazione	Designazione	
		960009 00000 960016 00100 960023 00100	BECKER LUBE M 100 (OLIO MINERALE) - 1L BECKER LUBE S 100 (OLIO SINTETICO) - 1L BECKER LUBE SL 100 (SETTORE ALIMENTARE) - 1L	
¹⁾ Serie di guarnizione - 549000 40500 - Pos.: 11, 12, 25, 26, 42, 55, 62, 65, 73, 91, 104, 106, 117, 147, 208 ²⁾ quantità di ordinazione necessari / manutenzione				

B INDICE	Pos.	No. De pedido	Descripción	
U 4.40	▣	549000 40500	JUNTA COMPLETA ¹⁾	
	4	500102 40500	CARCASA	
	6	020000 40500	ÉMBOLO	
	7	900585 00003	EMPUJADOR (KIT) ²⁾	
	8	000701 40500	TAPA LATERAL	
	9	945618 00000	VARILLA ROSCADA	
	14	945373 00000	TORNILLO HEXAGONAL INTERIOR	
	15	945374 00000	TORNILLO HEXAGONAL INTERIOR	
	16	947628 01000	PASADOR CILÍNDRICO	
	17	945801 01000	VARILLA ROSCADA	
	18	901807 00000	TORNILLO TERMINAL DE ÁRBOL	
	19	949203 00000	POLEA DENTADA	
	20	016800 05000	ARANDELA TENSORA	
	21	537500 26200	VÁLVULA COMPLETA	
	28	946917 00000	ESPÁRRAGO	
	29	917107 00000	MUELLE DE DISCO	
	30	947105 00000	TUERCA HEXAGONAL	
	36	068101 40500	APOYO	
	37	945634 00000	VARILLA ROSCADA	
	38	741310 60000	AMORTIGUADOR DE GOMA	
	44	867800 99559	FLOTADOR	
45	005001 40300	CRIBA		
47	727503 99628	VÁLVULA DE BARRIDO		
58	965414 00000	ELEMENTO DE DESACEITAR DE AIRE (1x) ²⁾		
59	016802 40300	ARANDELA TENSORA		
60	921500 50000	EMPUÑADURA		
63	003700 40500	TAPA		
66	945320 00000	TORNILLO HEXAGONAL INTERIOR		
67	953116 00000	TOBERA DE SILENCIADOR ACÚSTICO		
72	005000 40500	CRIBA		
74	945321 00000	TORNILLO HEXAGONAL INTERIOR		
82	960201 40500	REFRIGERADOR		
83	917800 40500	CHAPA LATERAL		
84	960702 40500	CAPERUZA DE VENTILADOR (~3)		
85	946308 00000	TORNILLO CILÍNDRICO		
86	948750 00000	REMACHE CIEGO		
89	912317 00000	TORNILLO DE EMPALME		
90	948407 00000	TORNILLO HUECO		
94	012207 40500	CONDUCTO (~3)		
95	012208 40500	CONDUCTO (~3)		
97	068100 40300	APOYO		
98	741310 80000	AMORTIGUADOR DE GOMA		
99	945218 00000	TORNILLO HEXAGONAL		
101	002402 40500	CARCASA DE SEPARADOR DE ACEITE		
103	907309 00000	CRISTAL MIRILLA DE ACEITE		
105	951219 00000	TORNILLO DE CIERRE		
107	951221 00100	TORNILLO DE CIERRE		
110	916800 10000	TAPA ROSCADA		
114	912318 00000	TORNILLO DE EMPALME		
115	003300 10700	TOBERA		
116	912300 00000	TORNILLO DE EMPALME		
118	009400 19000	TORNILLO DE PIEZA ESFÉRICA		
119	012200 40300	CONDUCTO		
197	741103 99682	GENERADOR DE NIVEL - OPCIONAL		
201	007801 40500	BRIDA ROSCADA		
203	537506 99633	VÁLVULA ANTIRRETORNO		
205	947701 00000	CHAVETA		
212	943402 60000	ELEMENTO TÉRMICO - OPCIONAL		

B INDICE	Pos.	No. De pedido	Descripción	
		960009 00000 960016 00100 960023 00100	BECKER LUBE M 100 (ACEITE MINERAL) - 1L BECKER LUBE S 100 (ACEITE SINTÉTICO) - 1L BECKER LUBE SL 100 (SECTOR ALIMENTARIO) - 1L	
¹⁾ Junta completa - 549000 40500 - Pos.: 11, 12, 25, 26, 42, 55, 62, 65, 73, 91, 104, 106, 117, 147, 208				
²⁾ cantidad necesario / mantenimiento				

U 4.40	Variante 	Pos. ²⁾	Bestell Nr. / Ident No. / No. Identification / No. Identificazione / No. De pedido		Beschreibung / Description / Designation / Designazione / Desripcion
			  	  	
① 1~ Einphasenwechselstrom 1~ single-phase AC 1~ AC monophasé 1~ AC monofase 1~ AC monofásica		84	960700 40500	960702 40500	LÜFTERHAUBE / VENTILATOR HOOD / CARTER DE VENTILATEUR / CARTER DEL VENTILATORE / CAPERUZA DE VENTILADOR
		94	012203 40500	012207 40500	LEITUNG / PIPE / TUYAU / CONDOTTO / CONDUCTO
		95	012204 40500	012208 40500	LEITUNG / PIPE / TUYAU / CONDOTTO / CONDUCTO
② /09 - mit Gasballastventil - with gas ballast valve - avec l'este d'air - con valvola di zavoratrice - con valvula de lastre de gas		8	000702 40500	000701 40500	SEITENDECKEL / LID / COUVERCLE / COPERCHIO / TAPA LATERAL
		190	768717 99626		GASBALLASTVENTIL / GAS BALLAST VALVE / L'ESTE D'AIR / VALVOLA DI ZAVORATRICE / VÁLVULA DE LASTRE DE GAS

²⁾ variantenabhängige Bauteile / variant-dependent components / composants variante-dependantes / componenti variante-dispendenti / componentes variante-dependientes